

Construction Hot Topics

Week of May 11, 2020

1. CTA Arrivals Level Roadway: Sky Way Restriping

- LAWA crews will close Arrivals Level Sky Way at the intersection of World Way North Wednesday night into Thursday this week to restripe the roadway
- The LAX-it and LAX Shuttle Stops at Terminal 1 will be temporarily relocated to the LAX FlyAway Shuttle Stop further west at Terminal 1
- Signage will be in place directing guests to the relocated stops

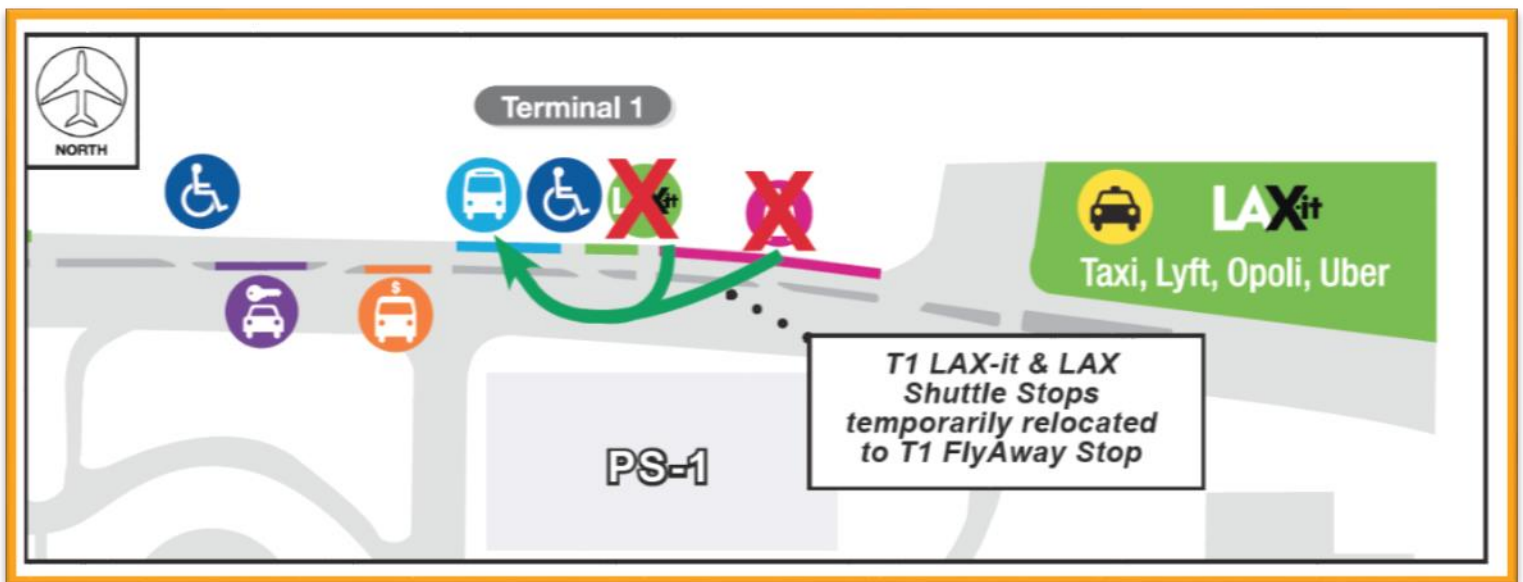

T1 LAX-it and LAX Shuttles temporarily relocated to T1 FlyAway stop

Change is in the Air(port).

LAX WAY BETTER. REALLY.

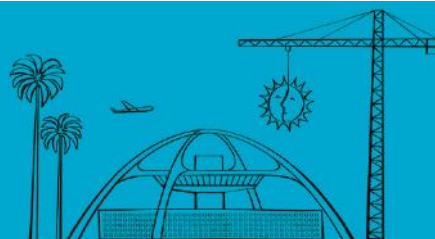

Construction Hot Topics

Week of May 11, 2020

2. CTA Arrivals Level Roadway: Theme Way Additional Closures

- To facilitate work for the Automated People Mover project, Theme Way from World Way is closed through Wednesday, April 27, 2022
- Beginning this Friday, May 15 through Wednesday, May 20, an additional portion of Center Way at Theme Way will close for work at that area
- Parking Structure 2A will egress backward on Center Way; flaggers and detour signage will be in place

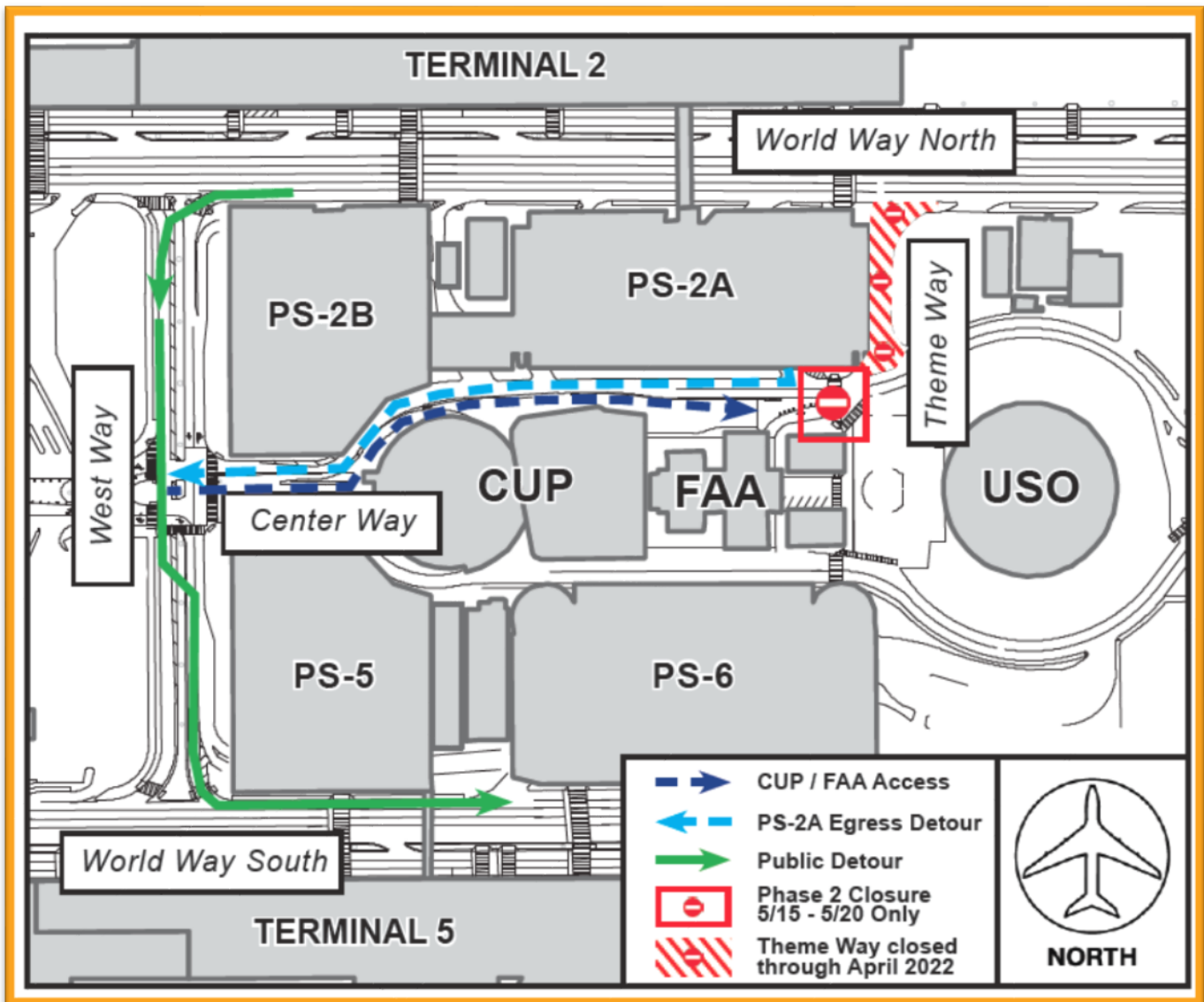

Theme Way and a portion of Center Way will be closed; traffic is detoured and flaggers will be present

Change is in the Air(port).

LAX WAY BETTER. REALLY.

